



Step Led

Lampada da parete. Diffusore in policarbonato opale. Struttura in pressofusione di alluminio, verniciatura in polvere poliestere con trattamento di fosfatazione. Viti in acciaio inox. Guarnizioni in gomma ai polimeri. Predisposta per il collegamento di un cavo di ingresso (alimentazione della rete) e un cavo di uscita (alimentazione degli apparecchi a "cascata" in parallelo). **Equipaggiata con led smd e alimentatore elettronico incorporato.**

Wall lamp. Diffuser made in opal polycarbonate. Structure made in die casting aluminium with polyester paint and phosphate treatment. Inox steel screws. Gaskets made in rubber. Ready to connect an input cable (mains supply) and an output cable (power to devices in "cascade" in parallel). **Equipped with smd led and electronic driver included.**

Lampe à mur. Diffuseur en polycarbonate opale. Structure réalisée en fonte d'aluminium. Vernis polyester traitement de phosphatation. Vis en acier inox. Joint en gomme. Prêt pour la connexion d'un câble d'entrée (alimentation secteur) et un câbles de sortie (puissance aux dispositifs de la "cascade" en parallèle). **Equipée avec led smd et ballast électronique incorporé.**

Lámpara de pared. Difusor de policarbonato opal. Estructura en fundición a presión de aluminio, pintura en polvo poliéster con tratamiento de fosfatación. Tornillos de acero inoxidable. Junta de protección de goma. Listo para la conexión de un cable de entrada (red eléctrica) y un cable de salida (energía a los dispositivos en "cascada" en paralelo). **Suministrada con led smd y alimentador electrónico incluido.**

Wandleuchte. Diffusor aus opalem Polycarbonat. Struktur aus Aludruckguss, Lackierung aus Polyester Pulver mit Phosphatierung. Schrauben aus Edelstahl. Dichtungen aus Polymergummi. Ausgestattet zum Anschließen einer Kabelnetz (Eingangsspannung) und einer Output-Kabel (Stromversorgung von Geräten in "Kaskade" parallel). **Ausgestattet mit LED smd. Eingebautem elektronischem Versorgungsgerät.**





Step 1 Led	Articolo <i>Item</i>	Colore struttura <i>Structure color</i>				W _{max}		LUMEN		LUMEN/W	
		AT	BI	GR	RU						

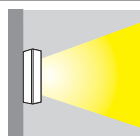
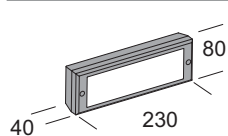

• Led	step 1 led-W	54587	54581	54586	54588	6,3	led	750	IP65	⊕	119	A
• Led	step 1 led-N	54597	54591	54596	54598	6,3	led	750	IP65	⊕	119	A

Step 2 Led

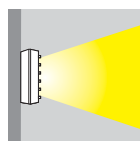
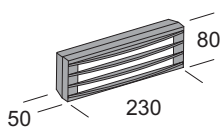

• Led	step 2 led-W	54607	54601	54606	54608	6,3	led	750	IP65	⊕	119	B
• Led	step 2 led-N	54617	54611	54616	54618	6,3	led	750	IP65	⊕	119	B

Step 3 Led

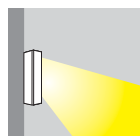
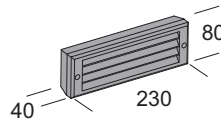

• Led	step 3 led-W	54627	54621	54626	54628	6,3	led	750	IP65	⊕	119	C
• Led	step 3 led-N	54637	54631	54636	54638	6,3	led	750	IP65	⊕	119	C

Colore struttura *Structure color*

• Nuova versione *New version*

AT RAL 7016 Antracite gofrato <i>Embossed anthracite</i>	BI RAL 9016 Bianco gofrato <i>Embossed white</i>	GR RAL 9006 Grigio gofrato <i>Embossed grey</i>	RU Ruggine <i>Rust</i>
---	---	--	----------------------------------

- Led Equipaggiata con led 3000K - *Equipped with led 3000K*
- Led Equipaggiata con led 4000K - *Equipped with led 4000K*

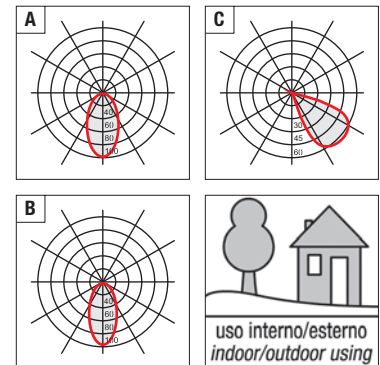

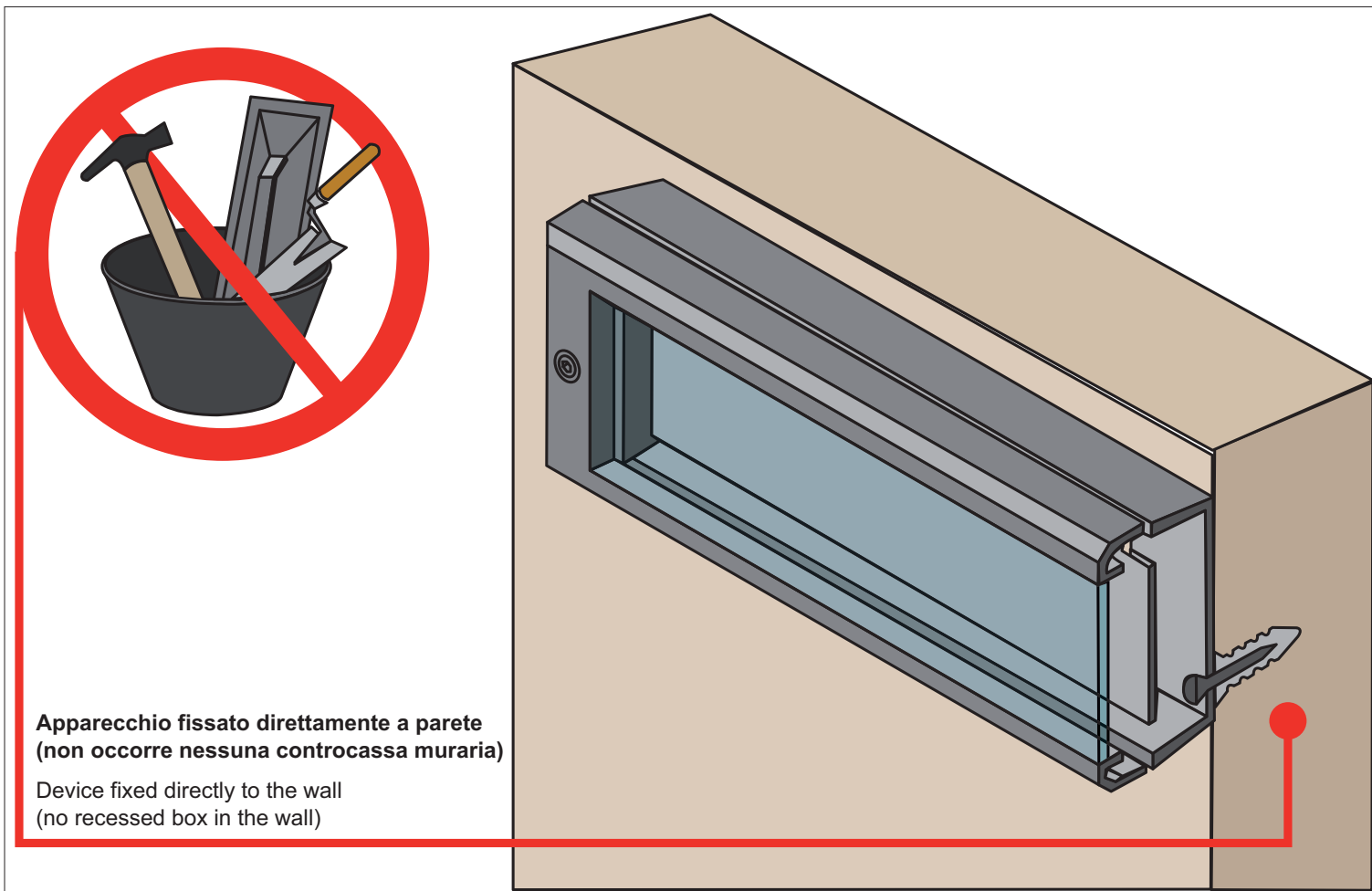

Apparecchio fissato direttamente a parete senza cassaforma nel muro.

Device fixed directly to the wall without recessed box in the cement.

Dispositif installé directement au mur sans boîtier d'encastrement.

Dispositivo instalado directamente a la pared sin caja de empotrar.

Wandleuchte installiert direkt auf einer Wand, ohne Wandschalung.